



PHOENIX

SPECIFICATIONS

VIVID SLIMLINE

FLUSH MOUNT CEILING SHOWER 300MM ROUND

PRODUCT CODE:	VS5090-00
FINISH:	CHROME
WELS:	3 STAR - 7.5 LT/MIN

INFORMATION:

TEMPERATURE RATING:	MIN 1° - MAX 75°
PRESSURE RATING:	MIN 150 kPa - MAX 500 kPa

CONSUMER UNIT:

SIZE:	L 320MM x W 320MM x H 100MM
GROSS WEIGHT:	.559 KG
BARCODE EAN-13:	9 320594 506 629

AVAILABLE IN:



CHROME

FOR MORE INFORMATION VISIT
www.phoenixtapware.com.au

MAINTENANCE AND CARE:

- All surfaces should be cleaned with mild liquid detergent or soap and water.
- Do not use cream cleaners or citrus based cleaning products, as they are abrasive.
- Use of unsuitable cleaning agents may damage the surface. Any damage caused in this way will not be covered by warranty.

PACKAGING INCLUDES

- 1 x Flush mount ceiling shower 300mm round
- 1 x 450mm braided flexible hose
- 1 x Spare nozzle kit
- 8 x Screw toggles
- 1 x Bracket
- 1 x Retaining ring
- 1 x Installation instructions
- 1 x Warranty card

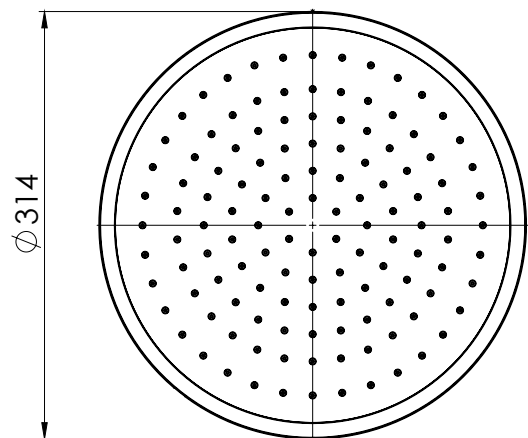
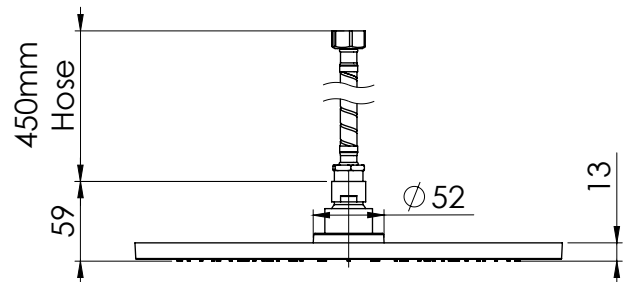

PLEASE [CLICK HERE TO VIEW FULL WARRANTY](#)



While we aim to ensure the specifications shown are correct at time of printing, Phoenix Tapware reserves the right to make modifications without prior notice. Always use the physical product measurements for mark-ups and roughing-in as the line drawing shown may differ from the actual product over time. All measurements are shown in millimetres.

www.phoenixtapware.com.au
03 9780 4200