

LINEAR INSTALLATION AND CLEANING INSTRUCTIONS

REN™
designer products

1 WALL MOUNTING

The towel rail is to be fixed to a solid wall being brick, cladded or timber framing. Warning: In order to avoid a hazard for young children, this appliance must be installed so that the bottom rail is at least 600mm above the floor.

2 INSTALLATION

- Hold the towel rail up against the wall in the desired position and outline the rail legs with a pencil see *diagram 1*
- Use a rail bush, centre it inside the rail outline and mark when the screw slot is in the bushes see *diagram 2*
- Drill a hole for the screw with a 6.5mm drill bit and insert nylon wall plug into tiled or masonry wall (if applicable) see *diagram 3*
- Screw rail bushes back to the wall ensuring they are centred in the pencil outline
- Slide towel rail onto the bushes up to the wall and screw the rail onto the bushes with screws supplied see *diagram 4*

3 ELECTRICAL

The electrical plug on the towel rail must be easily accessible after installation. If the optional concealed fixing is used, it must be installed by a qualified electrician and must be earthed. An isolating switch must be positioned near the towel rail. There needs to be an all-pole disconnection switch incorporated in the fixed wiring.

4 CARE AND CLEANING

The REN™ heated rail is manufactured from stainless steel, and should be given a wipe over with a soft cloth and non abrasive polish such as "Mr Sheen". Fine scratching can be removed using a metal polish such as "Brasso" or "Autosol".

- This appliance is not intended for use by young children or infirm persons unless they have been adequately supervised by a responsible person to ensure that they can use this appliance safely.
- Young children should be supervised to ensure they do not play with the appliance.
- If the supply cord is damaged it must be replaced by the manufacturer or its service agent in order to avoid a hazard.

5 SPECIFICATIONS

Voltage 230-240V AC 50Hz

Power 50W-250W

See product specification on individual rail and or packaging.

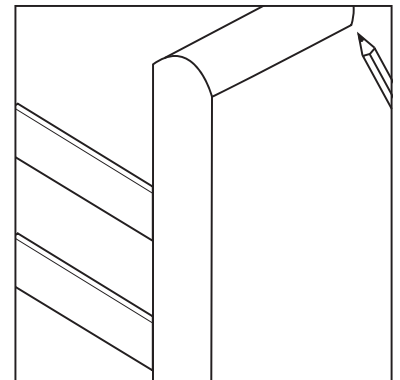

DIAGRAM 1

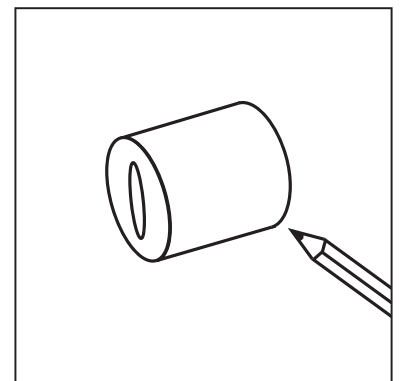

DIAGRAM 2

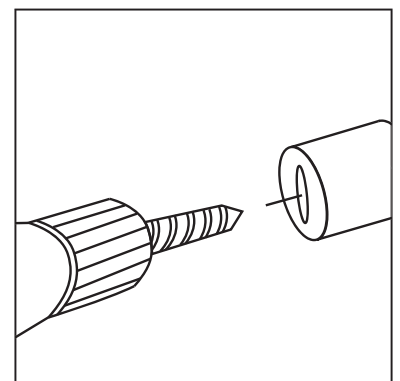

DIAGRAM 3

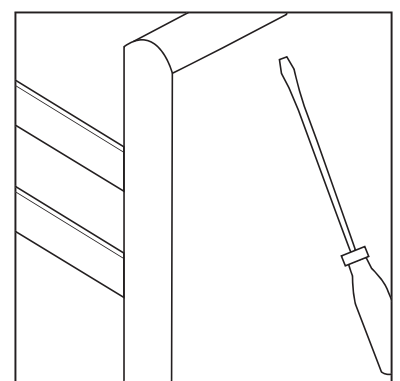

DIAGRAM 4